

austin gray  
first floor office 123-125 dyke road, hove, bn3 1tj  
Tel: 01273 232232  
residential@austingray.co.uk  
www.austingray.co.uk

austin gray



## 17 Charles Close

Hove, BN3 6WP

Price £500,000

A two bedroom detached bungalow in a quiet cul-de-sac in need of modernising and updating. No onward chain.

Charles Close is located in the Goldstone Valley district within easy access of the popular Hove Park with its sports and recreational facilities. Bus services run close by providing access into the vibrant city centre, seafront and promenade, while schools catering for all age groups are well represented within the local area.

The house is approached by a path leading to accommodation comprising of two double bedrooms, bathroom/WC, at the rear is the kitchen with a range of basic units and the lounge overlooks and has access out to the large, rear garden with mature trees and shrubs. At the front is a small, lawned garden and private drive leading up to an integral, single garage.

### Viewing

Please contact our Austin Gray Residential Office on 01273 232232

if you wish to arrange a viewing appointment for this property or require further information.



2



1



1



E



## Floor Plan

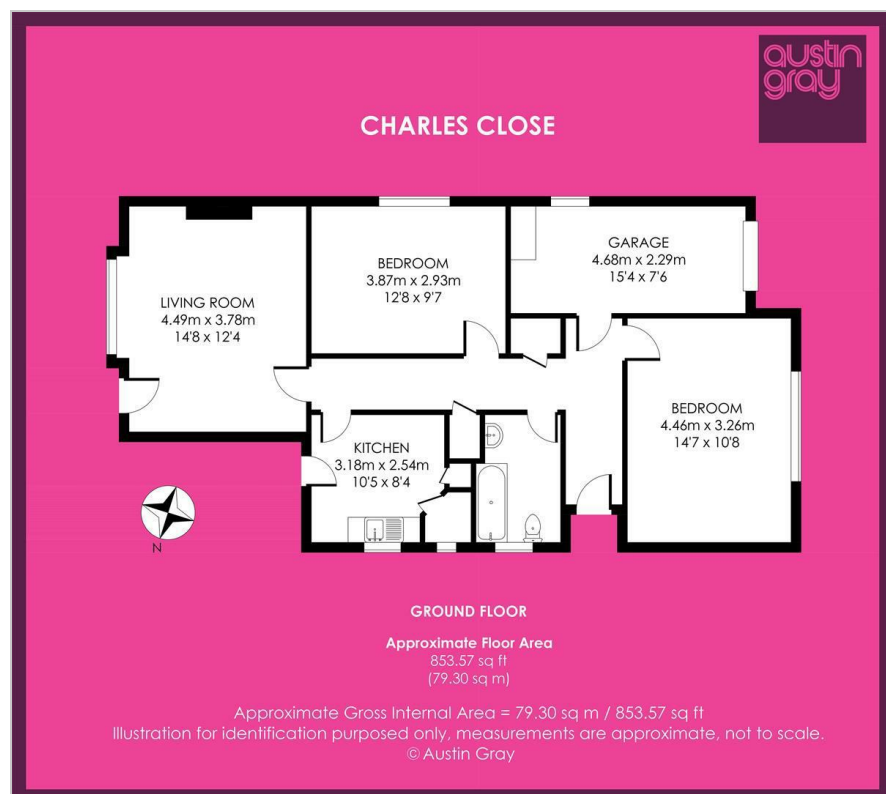

## Area Map



## Energy Efficiency Graph

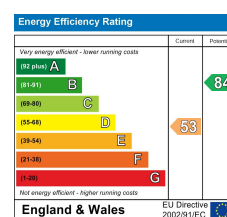

These particulars, whilst believed to be accurate are set out as a general outline only for guidance and do not constitute any part of an offer or contract. Intending purchasers should not rely on them as statements of representation of fact, but must satisfy themselves by inspection or otherwise as to their accuracy. No person in this firm's employment has the authority to make or give any representation or warranty in respect of the property.

austin gray  
first floor office 123-125 dyke road, hove, bn3 1tj  
Tel: 01273 232232  
residential@austingray.co.uk  
www.austingray.co.uk

austin gray